

Bollard, Model R-8400

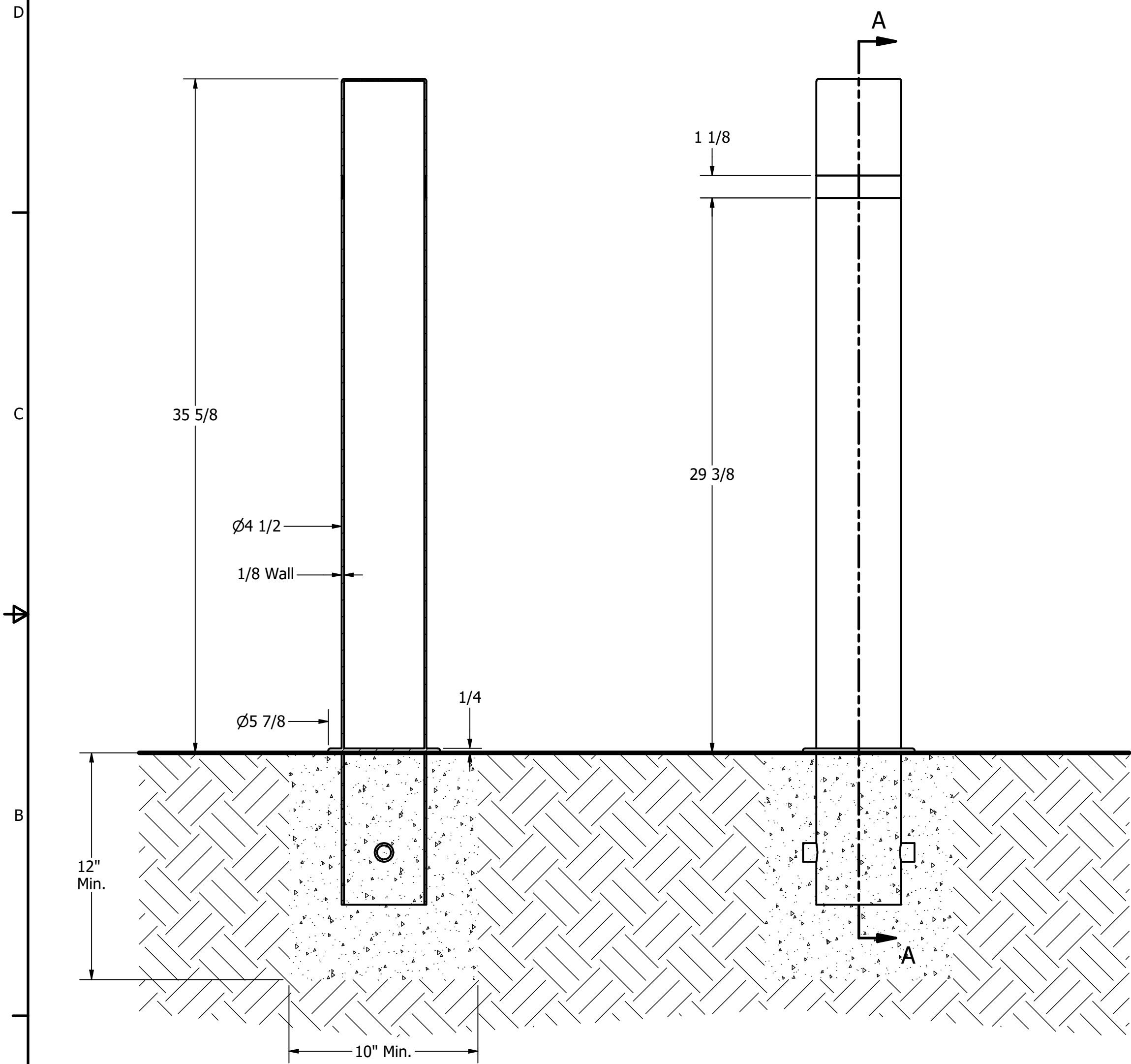

General Description:

The R-8400 Steel Bollard can be embedded in concrete for simple and secure installations. Its clean and versatile design is highly visible and available with alternative mountings (see retractable and removable models) for consistent aesthetics that suit any modern building or landscape. High-quality steel with polyester powder coat offers high resistance to corrosion and weathering. Posts ship standard with 1 of 4 colored reflector stripes.

For more information on bollard post installation, please visit: www.reliance-foundry.com/bollard/installation-bollards

Specifications:

Height: 35 5/8"

Base Diameter: 4 1/2"

Weight: 28 lbs

Material: Steel

Finish: Polyester Powder Coat

Reflective Tape Options:

- Yellow
- White
- Red
- Blue
- None (Default)

Notes:

SECTION A-A

- Embedment details are for reference illustration only. Minimum foundation sizes depend on local soil conditions, weather conditions, and engineering requirements.
- Bollard is provided as shown, with parts listed below. Concrete foundation and/or installation not provided by Reliance Foundry.
- This drawing is not drawn to scale. Dimensions provided herein is for reference only. Please consult Reliance Foundry sales professionals if any dimension is critical to your particular installation.
- Reliance Foundry reserves the right to amend design and specifications without prior notice for product improvement.

PARTS LIST					
ITEM	QTY	PART NUMBER	DESCRIPTION	MATERIAL	WEIGHT
1	1	R8400	R8400 Fixed Bollard	Steel	28 lbs
2	1	Reflective Tape (Optional)	Optional Reflective Tape, Max. 1-1/8" Width	Plastic	

RELIANCE FOUNDRY
— SINCE 1925 —

Unit 207, 6450 - 148 Street, Surrey, BC V3S 7G7, Canada
1-877-789-3245 info@reliance-foundry.com
www.reliance-foundry.com

TITLE			
Bollard R-8400			
SIZE	DWG NO	REV	
C	R8400	C1	